

# Evolve™ Casegoods

Kimball® Office



# Distinctive appearance.





Evoke calls forth admiration for beauty that performs flawlessly. Attention to detail and meticulous craftsmanship establish Evoke within the rich Kimball Office heritage of finely crafted wood. Evoke continues the legacy with innovative combinations of hardwoods in a range of rich finishes, lustrous metals, and frosted glass.

- Evoke's surfaces appear to "float" above pedestals to give the collection its signature appearance
- Peter Wooding Design Associates identified a wide array of exquisite materials that combine to create your desired image
- Evoke was recognized with a Best of NeoCon award

# Flexible performance.

Evoke can be arranged to provide an effective place to work, while addressing the individual's personal requirements. Choices among components, configurations, and materials allow Evoke to take on dramatically different looks even as it gives people what they need to perform at their best.





Undersurface project shelf with project tray



Storage cubbies are freestanding so they can be moved anywhere on the credenza worksurface



Cantilever shelves

- The flexibility of Evoke's offering accommodates the needs of different users with only slight specification changes
- Mobile pedestals fit conveniently under desk, credenza, return, or bridge surfaces
- Cantilever shelves attach to the back panel of highback organizers for added storage
- For convenient access to frequently used materials, project trays fit within a highback organizer or below a worksurface when combined with an undersurface project shelf
- Evoke intelligently provides additional floor level storage areas



# Capable assistance.

Evoke combines unique appearance with solutions for supporting technology that address individual work styles. The result is an award-winning balance between looking good and working well.

- Grommets or power/data centers route cords and wires away from the worksurface to eliminate tangles
- A wire management system with flexible covering is attached below the worksurface, to allow cords to enter and exit at any point
- The wire management system also provides cross-component cable routing
- A retractable laptop platform swivels, tilts, raises and lowers with a touch of the hand, or stows away when the computer is not in use

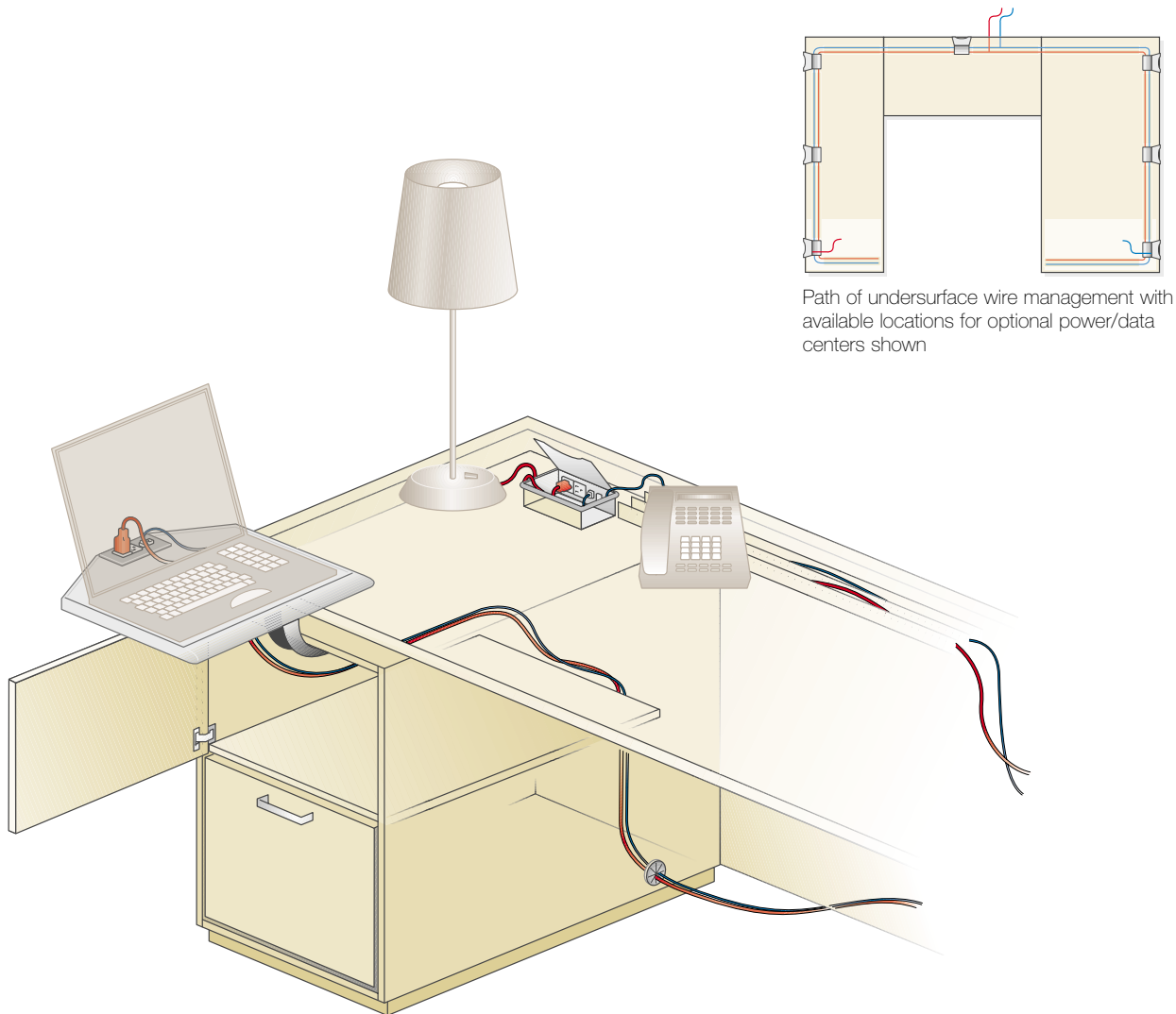



A **power/data center** provides convenient access at the desktop for instant connections



# Superb details.

Evoke joins exquisitely crafted hardwood veneers—just as one would expect given the Kimball Office heritage—with a wide variety of appealing elements. The resulting combinations express a range of personalities from transitional to contemporary.



Band Pull, Matte Black



Band Pull, Satin Nickel



Band Pull, Platinum



Ellipse Pull, Matte Black



Ellipse Pull, Satin Nickel



Ellipse Pull, Platinum



Buckle Pull, Matte Black



Buckle Pull, Satin Nickel



Buckle Pull, Platinum



Frosted Glass Overhead Door,  
Ellipse pull and frame in Platinum



Perforated Metal Overhead Door,  
Ellipse pull in Platinum



Wood Overhead Door, Natural Maple,  
Ellipse pull in Satin Nickel

- Three species of hardwood—cherry, maple and walnut—can be ordered in a total of 17 finishes
- Four edge details—cove, reveal, crown, and softened—are available on all worksurfaces
- Evoke offers three pull styles—band, ellipse, and buckle
- Doors and modesty panels are available in frosted glass, perforated metal and wood
- Metal pulls, doors, frames and modesty panels are available in three finishes—matte black, platinum, and satin nickel



Reveal Edge



Cove Edge



Crown Edge



Softened Edge

# Comprehensive choice.

Evoke encompasses all the elements required to furnish a space for productive work. Desks, credenzas, bridges, and returns provide expansive surface areas for working. Overhead storage units and highback organizers use space efficiently while keeping materials close at hand. Lateral files and bookcases handle bulk storage with ease.

- A full line of built-up units makes specification and installation easy and straightforward
- A range of modular components respond to personal storage requirements
- Choices among two heights of highback organizers, vertical storage, and overhead storage put space above workspaces to productive use



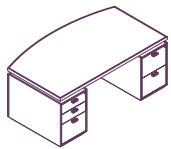

Double Pedestal Desk  
Arc Top

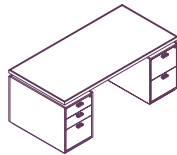

Double Pedestal Desk  
Rectangular Top

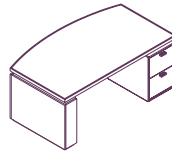

Single Pedestal Desk  
Arc Top

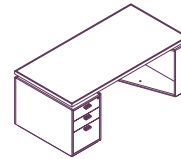

Single Pedestal Desk  
Rectangular Top

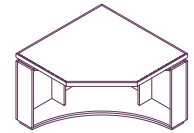

Corner Unit

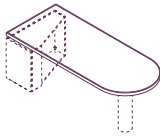

U-shaped Worksurface

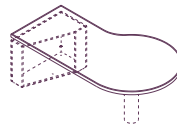

P-shaped Worksurface

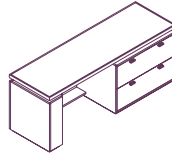

Lateral File Credenza

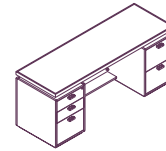

Kneespace Credenza

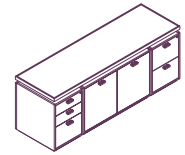

Storage Credenza

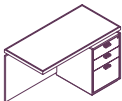

Return

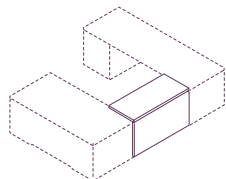

Bridge

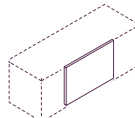

Modesty Panel

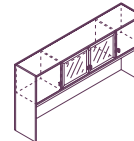

Highback Organizer

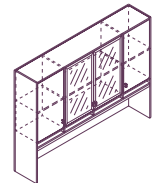

Highback Organizer

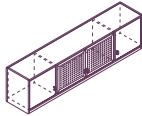

Overhead Storage

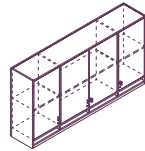

Overhead Storage

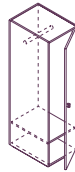

Single Door Wardrobe

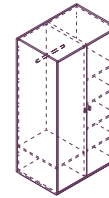

Storage Wardrobe

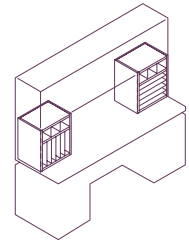

Storage Cubbies

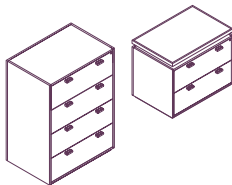

2-4 Drawer Lateral File

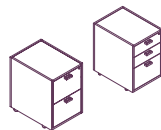

Box/Box/File Pedestal  
File/File Pedestal  
Component and Mobile

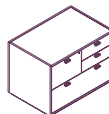

Multi-file

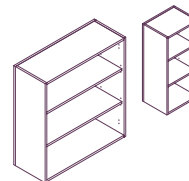

Open Bookcase

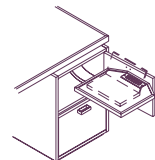

Retractable Laptop Arm

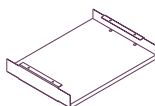

Undersurface Project Shelf

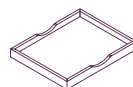

Project Tray

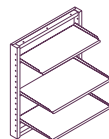

Cantilever Shelves



Tackboard

# Kimball® Office. A place that works for you.

## The Designer

Peter Wooding established Peter Wooding Design Associates in 1978, after practicing various design capacities within several international corporations. His practice embraces a multidisciplinary approach and has produced award-winning designs for interiors, consumer products, furniture, systems and graphics. He has taught and lectured at a variety of institutions, including the Rhode Island School of Design, the University of Michigan, the Taipei Institute of Technology (Taiwan) and the Muchina School of Art and Design (St. Petersburg, Russia). As a former President of the Industrial Designers Society of America (IDSA), Wooding continues to be a spokesperson for design excellence.

Click. Save. Print.

Product images and other information available at:

[www.kimballoffice.com](http://www.kimballoffice.com)



A Unit of Kimball International 1600 Royal Street Jasper, Indiana 47549 800.482.1818

Due to the limitations of the printing process, printed colors may vary from actual finish samples.  
Product details and other data are subject to change without notice.  
Your Customer Care Team will be happy to answer any questions you may have.

Cover product specifications: Espresso Walnut, Reveal Edge, Ellipse pull and Perforated Metal Overhead Doors in Satin Nickel finish.